

## AH - Hydraulic pullers

- Rugged design.
- Safe and stable pull operations as piston is non rotating.
- Self straining.

NIKE's hydraulic pullers are designed for tough industrial applications and are available in sizes from 5 ton to 44 ton. The rugged design will make this a work-horse for many years to come. The benefits of a hydraulic puller, compared with a mechanical one, are many; the most important is a non rotating piston / press head. This allows the user to carry out the pull safely without the risk of slipping.

The smaller sizes, 5 ton and 10 ton, are equipped with special mechanics which self centers the arms. The arms will therefore always adapt to the diameter of the object and have the best possible grip and handling. All NIKE pullers are furthermore self straining and have an extra long stroke. The pull depth can easily be adjusted by moving the arm attachments.

The pullers can be used with 2 or 3 arms (not the AH450 - only 3 arms). Different lengths of arm are available as accessories.

**Choose a suitable pump kit** - all NIKE pumps fit our pullers but we recommend either our PHS70-1000/LS201 kit or rather the air driven foot pump type PP70A-1000/LS201. Both types are equipped with a 2 m hose, a swivel and a NIKE quick coupling.

They are also sold as stand alone units without the hydraulics; A50, A110, A200 and A450 - if the user already has a suitable cylinder.



# Technical data



## Accessories

### AMK801 - Gauge kit

A smart and safety improving accessory which lets you monitor the pull process. NIKE quick couplings allows an easy connection between cylinder and pump.

### Puller arms 110-280

Puller arms 110-280 are delivered as standard with the A/AH110 and have a pull length of 280 mm.

### Puller arms 110-390

Puller arms with different lengths can be used when the standard arms are too short. Puller arms 110-390 fits A/AH110 and have a pull length of 390 mm.

### Puller arms 110-490

Puller arms with different lengths can be used when the standard arms are too short. Puller arms 110-490 fits A/AH110 and have a pull length of 490 mm.

### Puller arms 200-400

Puller arms 200-400 are delivered as standard with the A/AH200 and have a pull length of 400 mm.

### Puller arms 450-680

Puller arms 450-680 are delivered as standard with the A/AH450 and have a pull length of 680 mm.

### Puller arms 50-220

Puller arms 50-220 are delivered as standard with the A/AH50 and have a pull length of 220 mm.

### Security chain 20-20

We strongly recommend use of a safety chain whenever working with pullers. The chain prevents the arms from sliding and thus protects both the user and device.

Dimensional drawing AH50/110

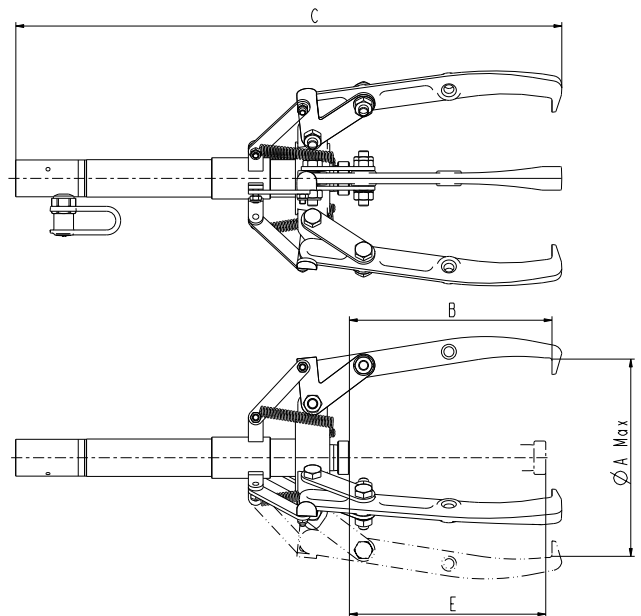
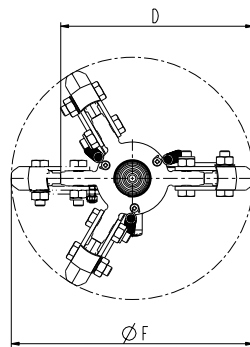

Dimensional drawing AH200/450

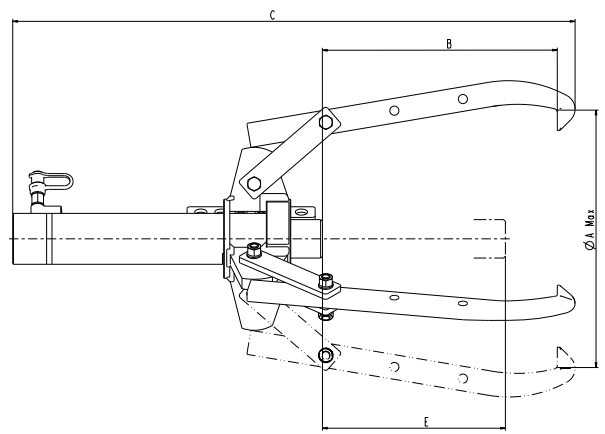
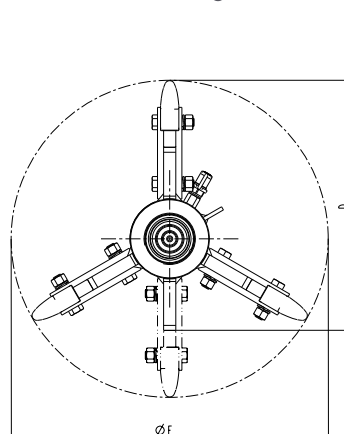

Name	Capacity kN (t)	A ø mm	B mm	C mm	D mm	E mm	F ø mm
AH50	49 (5)	250	225	557	197	232	250
AH110	111 (11)	400	262	747	276	305	322
AH200	200 (20)	500	385	922	410	311	520
AH450	450 (46)	700	678	1060	485	200	635



[www.nikehydraulics.com](http://www.nikehydraulics.com)

**NIKE HYDRAULICS AB**  
Box 1107  
631 80 Eskilstuna  
SWEDEN  
Tel +46 16 - 16 82 00  
Fax +46 16 - 13 93 16  
[info@nikehydraulics.se](mailto:info@nikehydraulics.se)

**NIKE HYDRAULICS Inc.**  
3980 W. Albany, Unit #1  
MCHENRY, IL 60050  
USA  
Tel + 1 815 385 7777  
Fax + 1 815 385 7776  
[info@nikehydraulics.com](mailto:info@nikehydraulics.com)

**NIKE POWER EQUIPMENT Ltd.**  
Unit 6, Stechford Trading Estate  
Lyndon Road, Stechford  
BIRMINGHAM B33 8BU, UK  
Tel +44 121 789 77 07  
Fax +44 121 789 68 66  
[info@nikehydraulics.co.uk](mailto:info@nikehydraulics.co.uk)

# AHV50-110 Puller buggy



- The puller buggy with accessories.
- Easy to use and portable.
- Puller buggy serving as a working place.

## Data sheet

# Technical data



## Examples of accessories and included parts.

### 215-2 Knife puller

Knivavdragare med spännområde 15-115mm.

### 215-3 Knife puller

Knivavdragare med spännområde 25-155mm.

### AH110 - Hydraulic puller

The hydraulic puller AH110 (110 kN) is designed for tough industrial applications. For detailed technical data on the puller, please see separate data sheet.

### AH50 - Hydraulic puller

The hydraulic puller AH50 (49 kN) is designed for tough industrial applications. For detailed technical data on the puller, please see separate data sheet.

### AMK801 - Gauge kit

A smart and safety improving accessory which lets you monitor the pull process. NIKE quick couplings allows an easy connection between cylinder and pump.

### AMK802 - Gauge kit

A smart and safety improving accessory which lets you monitor the pull process. NIKE quick couplings allows an easy connection between cylinder and pump. To improve coupling and general flexibility, we have added a 1 m high pressure hose to the kit. To minimize the risk of damaging the gauge, a rubber gauge protection ring is included.

### Puller arms 110-390

Puller arms with different lengths can be used when the standard arms are too short. Puller arms 110-390 fits A/AH110 and have a pull length of 390 mm.

### Puller arms 110-490

Puller arms with different lengths can be used when the standard arms are too short. Puller arms 110-490 fits A/AH110 and have a pull length of 490 mm.

### Security chain 20-20

We strongly recommend use of a safety chain whenever working with pullers. The chain prevents the arms from sliding and thus protects both the user and device.

Hydraulic pullers are heavy tools. Especially when you need the tool on a day-by-day basis. This is where the puller buggy comes in very handy. The hydraulic pullers and the accessories stay in one single place, easy accessible when you need them. The puller buggy is equipped with 4 swiveling wheels, two of them lockable.

Furthermore, thanks to the winch, the puller buggy itself serves as a working platform. For example, you can adjust the working position of the pullers with the winch with high precision. This is not only a time and effort saving help but is also very important from a safety precaution point. There is no need for somebody to have to manually hold the puller during operation - attach the puller and step aside.

The puller buggy is delivered as standard with the following items:

- TV50-110 - Buggy with winch
- AH50 - 5 T Puller
- AH110 - 10 T Puller
- EAT50-110 - Push mandrel kit
- PP70-1000/LS251ES - Pump with hose and couplings
- AMK802 - Gauge kit
- 110-390 - Puller arms
- 110-490 - Puller arms
- 20-20 - Safety chain

Two additional accessory kits are available:

- PK50 - Pin- knife puller kit 5 T
- PK110 - Pin- knife puller kit 10 T

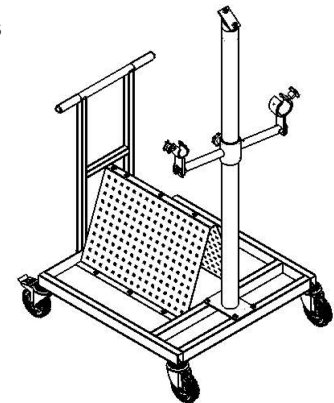

### EAT50-110 Push mandrel kit

Name	Diameter mm	Length mm
Push mandrel 50-18/90	18	90
Push mandrel 50-23/90	23	90
Push mandrel 50-23/140	23	140
Push mandrel 50-32/50	32	50
Push mandrel 50-32/75	32	75
Adapter 110-35/35	-	-

Name	Working press. MPa	Capacity	Length mm	Width mm	Height mm	Weight kg
AVH50-110	70	49kN - 110kN	800	800	1650	93



[www.nikehydraulics.com](http://www.nikehydraulics.com)

**NIKE HYDRAULICS AB**  
Box 1107  
631 80 Eskilstuna  
SWEDEN  
Tel +46 16 - 16 82 00  
Fax +46 16 - 13 93 16  
[info@nikehydraulics.se](mailto:info@nikehydraulics.se)

**NIKE HYDRAULICS Inc.**  
3980 W. Albany, Unit #1  
MCHENRY, IL 60050  
USA  
Tel + 1 815 385 7777  
Fax + 1 815 385 7776  
[info@nikehydraulics.com](mailto:info@nikehydraulics.com)

**NIKE POWER EQUIPMENT Ltd.**  
Unit 6, Stechford Trading Estate  
Lyndon Road, Stechford  
BIRMINGHAM B33 8BU, UK  
Tel +44 121 789 77 07  
Fax +44 121 789 68 66  
[info@nikehydraulics.co.uk](mailto:info@nikehydraulics.co.uk)